

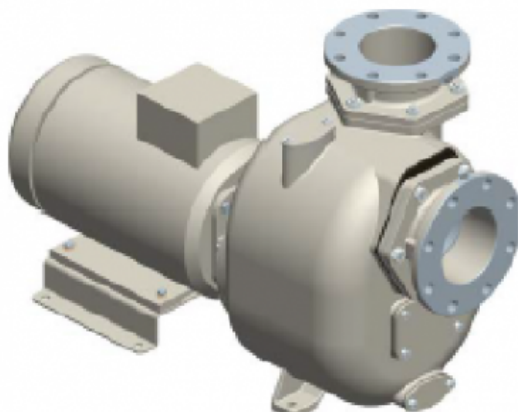

S161 G31T+F



**Product codes:**

Reference: 13578.02

**Product short description:**

6" Self-priming centrifugal pump in cast iron with mechanical seal, grease-lubricated, non return valve and 18,5 kW electric motor close coupled  
**+F flange coupling according DIN. PN16**

**Product features:**

Main Features
Pump series: S161
Pump Flow Rate: max 350 m <sup>3</sup> /h (5500 l/min)
Pump head with 50 Hz grid frequency: max 20 m
Max. Solids Handling: 54 mm
Self-priming: ★★★★★☆
Heavy-duty: ★★★★★☆
Construction: Close Coupled
Pump
Type of Pump: Self-priming centrifugal pump
Suction port: DN150
Discharge port: DN150
Type of ports: DIN PN16 flange (compatible), ANSI 150lb flange
Type of self-priming: Wet-prime



Inspection cover for the impeller: Yes
Filling port: Yes
Drain Port: Yes
Plug for Vacuometer: Yes
Plug for the Manometer: Option
Material of casing: Cast iron
Material of impeller: Ductile Cast-iron
Material of wear plate: Steel
Material of shaft: Stainless steel AISI420
Material of non-return valve: NBR (Nitrile)
Shaft sealing: YCV Mechanical Seal with Grease Lubrication in SiC/SiO <sub>2</sub> /FKM (Viton®) on Stainless Steel Sleeve
<b>Drive</b>
Type of drive unit: Three-Phase Electric Motor
Drive Manufacturer: Victor Pumps
Efficiency class: IE1, S6-75%
Rated Power: 18, 5 kW
Maximal Rotation: 1450 rpm (50 Hz)
Rated voltage: 400 V $\pm 10\%$ @ 50 Hz, 690 V $\pm 10\%$ @ 50 Hz
Protection: 45 Amp (380-480 V), 26 Amp (660-725 V)
Cooling method: IC411- TEFC
Protection degree: IP55
Insulation class: F
<b>Performance data</b>
Typical application: waste water with solids in suspension, non-corrosive
Product temperature: max. 60 °C
Ambient temperature: max. 40 °C
Density: up to 1, 4 kg/dm <sup>3</sup> , for higher values you need an oversized motor
Viscosity: up to 30 mm <sup>2</sup> /s (cSt), for higher values you need an oversized motor
Max vacuum with water: max 8 m (9, 5 m for 10 min)
Max vacuum with air: max 7, 5 m
<b>Additional Features</b>
Setup position: Horizontal
Coupling: One shaft solution without any coupling
Paint: RAL6011 Reseda green
External Dimensions (L x W x H): 1097 x 520 x 650 mm
Net Weight: 307 kg

