

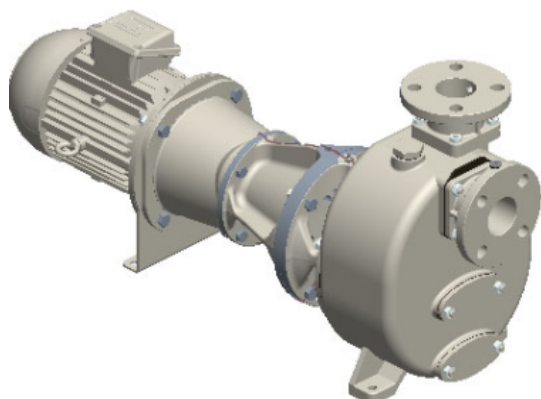

S 65 G31BBT+F



Product codes:

Reference: 4066.242

Product short description:

2" Self-priming centrifugal pump in cast iron with mechanical seal, grease-lubricated, non return valve and 2,2 kW electric motor Bi-Block (B5 standard motor flange-mounted on the pump bearing bracket)
+F flange coupling according DIN. PN16

Product features:

| Main Features |
|--|
| Pump series: S 65 |
| Pump Flow Rate: max 40 m ³ /h (655 l/min) |
| Pump head with 50 Hz grid frequency: max 13 m |
| Max. Solids Handling: 25 mm |
| Self-priming: ★★☆☆☆ |
| Heavy-duty: ★★★★★ |
| Construction: Bi-Block |
| Pump |
| Type of Pump: Self-priming centrifugal pump |
| Suction port: DN50 |
| Discharge port: DN50 |
| Type of ports: DIN PN16 flange (compatible), ANSI 150lb flange |
| Type of self-priming: Wet-prime |
| Inspection cover for the impeller: Yes |
| Filling port: Yes |



| |
|---|
| Drain Port: Yes |
| Plug for Vacuometer: Yes |
| Plug for the Manometer: Yes |
| Material of casing: Cast iron |
| Material of impeller: Cast iron |
| Material of wear plate: Steel |
| Material of shaft: Stainless steel AISI316 |
| Material of non-return valve: NBR |
| Shaft sealing: YCV Mechanical Seal with Grease Lubrication in SiC/SiO ₂ /FKM (Viton®) on Stainless Steel Sleeve |
| Drive |
| Type of drive unit: Three-Phase Electric Motor |
| Drive Manufacturer: WEG |
| Efficiency class: IE3 |
| Rated Power: 2, 2 kW |
| Maximal Rotation: 1450 rpm (50 Hz) |
| Rated voltage: 400 V $\pm 10\%$ @ 50 Hz, 230 V $\pm 10\%$ @ 50 Hz |
| Protection: 7 Amp (380-480 V), 10 Amp (220-277 V) |
| Mounting: B5 |
| Frame: IEC 100L |
| Cooling method: IC411- TEFC |
| Protection degree: IP55 |
| Insulation class: F |
| Performance data |
| Typical application: waste water with solids in suspension, non-corrosive |
| Product temperature: max. 90 °C |
| Ambient temperature: max. 40 °C |
| Density: up to 1, 1 kg/dm ³ , for higher values you need an oversized motor |
| Viscosity: up to 5 mm ² s (cSt), for higher values you need an oversized motor |
| Max vacuum with water: max 8 m (9, 5 m for 10 min) |
| Max vacuum with air: max 6 m |
| Additional Features |
| Setup position: Horizontal |
| Coupling: coupling integrated in the bearing-house |
| Paint: RAL6011 Reseda green |
| External Dimensions (L x W x H): see dimensions |
| Net Weight: see dimensions |

Product gallery:

