

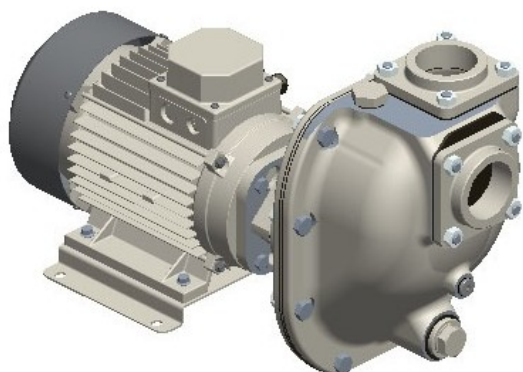

S 51+50 K312T+PS



Product codes:

Reference: 2503.01

Product short description:

2" Self-priming centrifugal pump in stainless steel with mechanical seal, grease-lubricated, non return valve and 2,2 kW electric motor close coupled
+PS automatic lubricator for mechanical seal

Product features:

Main Features
Pump series: S 51+50
Pump Flow Rate: max 40 m ³ /h (655 l/min)
Pump head with 50 Hz grid frequency: max 16 m
Max. Solids Handling: 25 mm
Self-priming: ★★☆☆☆
Heavy-duty: ★★★★★
Construction: Close Coupled
Pump
Type of Pump: Self-priming centrifugal pump
Suction port: 2"
Discharge port: 2"
Type of ports: Female Thread BSP
Type of self-priming: Wet-prime
Inspection cover for the impeller: Yes
Filling port: Yes



Drain Port: Yes
Plug for Vacuometer: Option
Plug for the Manometer: Option
Material of casing: Stainless steel
Material of impeller: Stainless steel
Material of wear plate: Stainless steel
Material of shaft: Stainless steel AISI316
Material of non-return valve: FKM (Viton)
Shaft sealing: YCV Mechanical Seal with Grease Lubrication in SiC/SiO ₂ /FKM (Viton®) on Stainless Steel Sleeve
Drive
Type of drive unit: Three-Phase Electric Motor
Drive Manufacturer: Victor Pumps
Efficiency class: IE2, S6-75%, (IE3 on request)
Rated Power: 2, 2 kW
Maximal Rotation: 2900 rpm (50 Hz)
Rated voltage: 400 V ±10% @ 50 Hz, 230 V ±10% @ 50 Hz
Protection: 7 Amp (380-480 V), 10 Amp (220-277 V)
Cooling method: IC411- TEFC
Protection degree: IP55
Insulation class: F
Performance data
Typical application: waste water with solids in suspension, non-corrosive
Product temperature: max. 60 °C
Ambient temperature: max. 40 °C
Density: up to 1, 1 kg/dm ³ , for higher values you need an oversized motor
Viscosity: up to 30 mm ² s (cSt), for higher values you need an oversized motor
Max vacuum with water: max 8 m (9, 5 m for 10 min)
Max vacuum with air: max 7, 5 m
Additional Features
Setup position: Horizontal
Coupling: One shaft solution without any coupling
Paint: RAL6011 Reseda green
External Dimensions (L x W x H): see dimensions
Net Weight: see dimensions

Product gallery:

S 51 - 50 Hz

Umschließung
Speed: ~ 2000 mm/s
Vorteile:

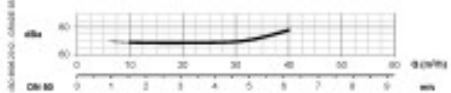
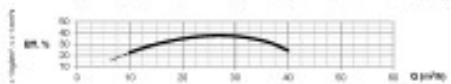
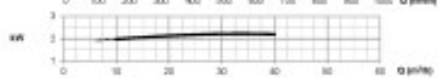
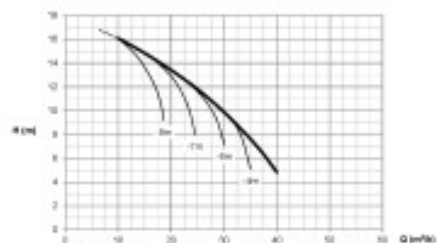

© 2004 Blackwell Publishing Ltd, *Journal of Internal Medicine* 255: 103–110

www.elsevier.com/locate/jmr

bioRxiv preprint doi: <https://doi.org/10.1101/2018.06.23.259114>; this version posted June 23, 2018. The copyright holder for this preprint (which was not certified by peer review) is the author/funder, who has granted bioRxiv a license to display the preprint in perpetuity. It is made available under aCC-BY-NC-ND 4.0 International license.

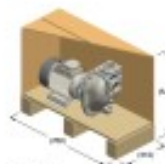
$$R^2 = 0.13$$
 $\log = 45$ 